

Estimated manufacturing time:
6 weeks from the
time of LSI order acceptance.

Single Hex Deck Structure
PlayBooster®
(5-12 years)

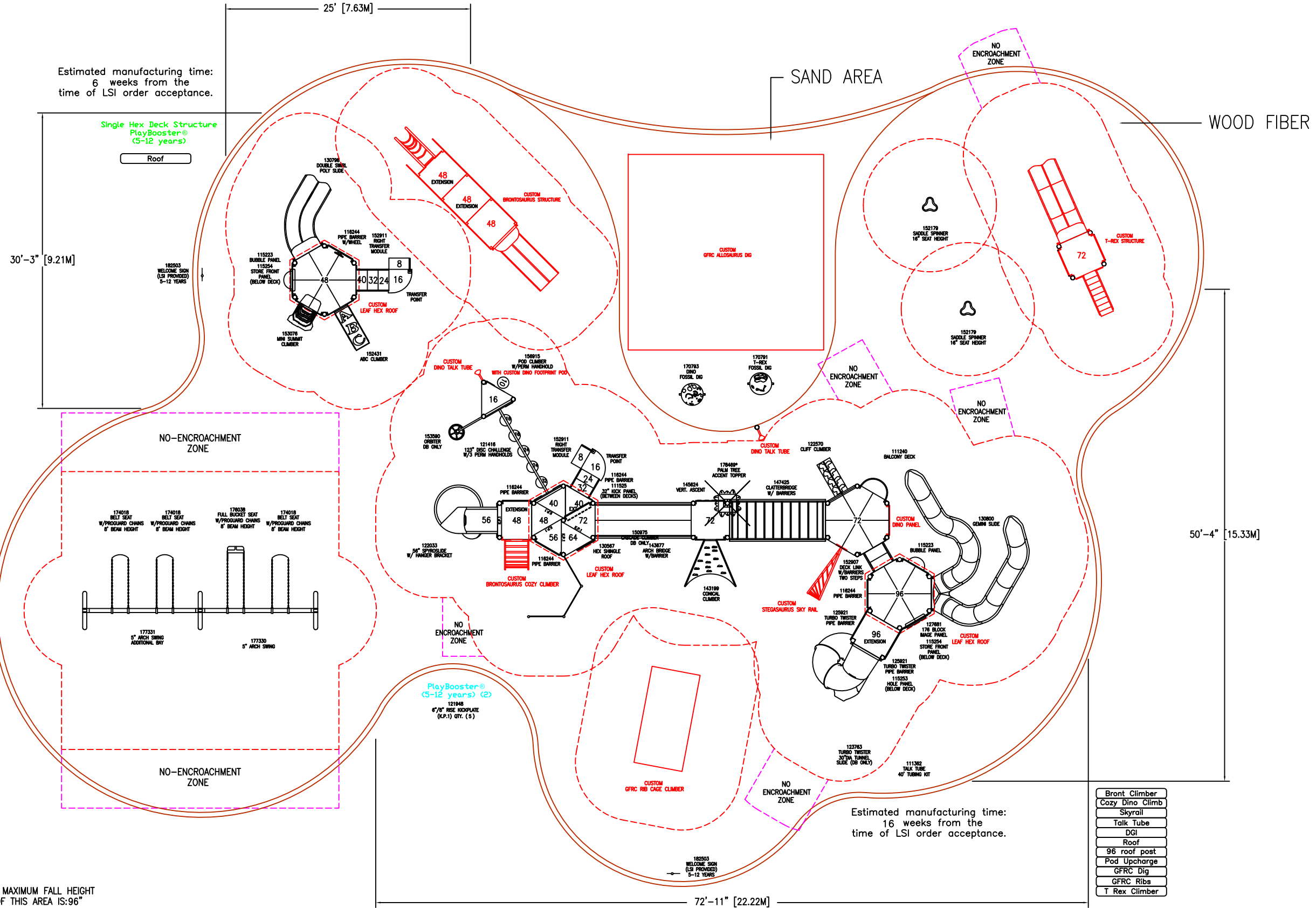

30'-3" [9.21M]

25' [7.63M]

WOOD FIBER

NO-ENCROACHMENT ZONE

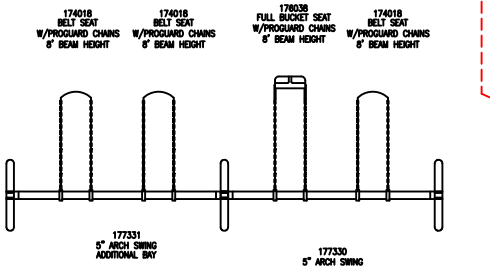

NO-ENCROACHMENT ZONE

SAND AREA

Estimated manufacturing time:
16 weeks from the
time of LSI order acceptance.

72'-11" [22.22M]

THE MAXIMUM FALL HEIGHT
OF THIS AREA IS: 96"

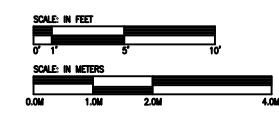

Pipestone Creek
Dinosaur Playground
Grand Prairie, AB.

SYSTEM TYPE:
PlayBooster
DRAWING #:
42079-2-3

- Bront Climber
- Cozy Dino Climb
- Skyrail
- Talk Tube
- DGI
- Roof
- 96 roof post
- Pod Upcharge
- GFRC Dig
- GFRC Ribs
- T Rex Climber

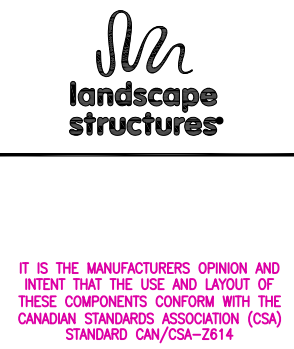

THIS PLAY AREA & PLAY EQUIPMENT IS
DESIGNED FOR AGES 5-12 YEARS
UNLESS OTHERWISE NOTED ON PLAN.

THIS CONCEPTUAL PLAN WAS BASED ON
INFORMATION AVAILABLE TO US. PRIOR TO
CONSTRUCTION, DETAILED SITE INFORMATION
INCLUDING SITE DIMENSIONS, TOPOGRAPHY, EXISTING
UTILITIES, SOIL CONDITIONS, AND DRAINAGE
SOLUTIONS SHOULD BE OBTAINED, EVALUATED, &
UTILIZED IN THE FINAL DESIGN. PLEASE VERIFY ALL
DIMENSIONS OF PLAY AREA, SIZE, ORIENTATION, AND
LOCATION OF ALL EXISTING UTILITIES, EQUIPMENT,
AND SITE FURNISHINGS PRIOR TO ORDERING. SLIDES
SHOULD NOT FACE THE HOT AFTERNOON SUN.

CHOOSE A PROTECTIVE SURFACING MATERIAL THAT
HAS A CRITICAL HEIGHT VALUE TO MEET THE
MAXIMUM FALL HEIGHT FOR THE EQUIPMENT (REF.
ASTM F1487 STANDARD CONSUMER SAFETY
PERFORMANCE SPECIFICATION FOR PLAYGROUND
EQUIPMENT FOR PUBLIC USE, SECTION 8 CURRENT
REVISION). THE SUBSURFACE MUST BE WELL
DRAINED. IF THE SOIL DOES NOT DRAIN NATURALLY
IT MUST BE TILED OR SLOPED 1/8" TO 1/4" PER
FOOT TO A STORM SEWER OR A "FRENCH DRAIN".

ACCESSIBLE/PROTECTIVE
LOOSE FILL MATERIAL
(ENGINEERED WOOD FIBER SUGGESTED)

DESIGNED BY:

COPYRIGHT: 2011
LANDSCAPE STRUCTURES, INC.
601 7th STREET SOUTH - P.O. BOX 198
DELANO, MINNESOTA 55328
PH: 1-800-328-0035 FAX: 1-763-972-6091

| Date | Previous Drawing # | Initials |
|------|--------------------|----------|
| | | |

