



The play components identified on this plan are IPEMA certified. (Unless model number is preceded with #) The use and layout of these components conform to the requirements of ASTM F1487. To verify product certification, visit www.ipema.org

THIS LAYOUT INCLUDES FITNESS EQUIPMENT FOR USERS AGES 13 AND OLDER. FITNESS EQUIPMENT THAT IS DESIGNED FOR AGES 13 AND OLDER DOES NOT FALL UNDER THE SCOPE OF ASTM F1487 - THE STANDARD CONSUMER SAFETY PERFORMANCE SPECIFICATION FOR PLAYGROUND EQUIPMENT FOR PUBLIC USE. AGE APPROPRIATE SIGNAGE IS RECOMMENDED.

THIS PLAY AREA & PLAY EQUIPMENT IS DESIGNED FOR AGES 5-12 YEARS UNLESS OTHERWISE NOTED ON PLAN.

IT IS THE MANUFACTURERS OPINION THAT THIS PLAY AREA DOES CONFORM TO THE A.D.A. ACCESSIBILITY STANDARDS, ASSUMING AN ACCESSIBLE PROTECTIVE SURFACING IS PROVIDED, AS INDICATED, OR WITHIN THE ENTIRE USE ZONE.

THIS CONCEPTUAL PLAN WAS BASED ON INFORMATION AVAILABLE TO US. PRIOR TO CONSTRUCTION, DETAILED SITE INFORMATION INCLUDING SITE DIMENSIONS, TOPOGRAPHY, EXISTING UTILITIES, SOIL CONDITIONS, AND DRAINAGE SOLUTIONS SHOULD BE OBTAINED, EVALUATED, & UTILIZED IN THE FINAL DESIGN. PLEASE VERIFY ALL DIMENSIONS OF PLAY AREA, SIZE, ORIENTATION, AND LOCATION OF ALL EXISTING UTILITIES, EQUIPMENT, AND SITE FURNISHINGS PRIOR TO ORDERING. SLIDES SHOULD NOT FACE THE HOT AFTERNOON SUN.

CHOOSE A PROTECTIVE SURFACING MATERIAL THAT HAS A CRITICAL HEIGHT VALUE TO MEET THE MAXIMUM FALL HEIGHT FOR THE EQUIPMENT (REF. ASTM F1487 STANDARD CONSUMER SAFETY PERFORMANCE SPECIFICATION FOR PLAYGROUND EQUIPMENT FOR PUBLIC USE, SECTION 8 CURRENT REVISION). THE SUBSURFACE MUST BE WELL DRAINED. IF THE SOIL DOES NOT DRAIN NATURALLY IT MUST BE TILED OR SLOPED 1/8" TO 1/4" PER FOOT TO A STORM SEWER OR A "FRENCH DRAIN".

AREA OF ACCESSIBLE/PROTECTIVE SURFACING (POURED-IN-PLACE SUGGESTED)

DESIGNED BY:

COPYRIGHT: 2013
LANDSCAPE STRUCTURES, INC.
601 7th STREET SOUTH - P.O. BOX 198
DELANO, MINNESOTA 55328
PH: 1-800-328-0035 FAX: 1-763-972-6091

Date Previous Drawing # Initials

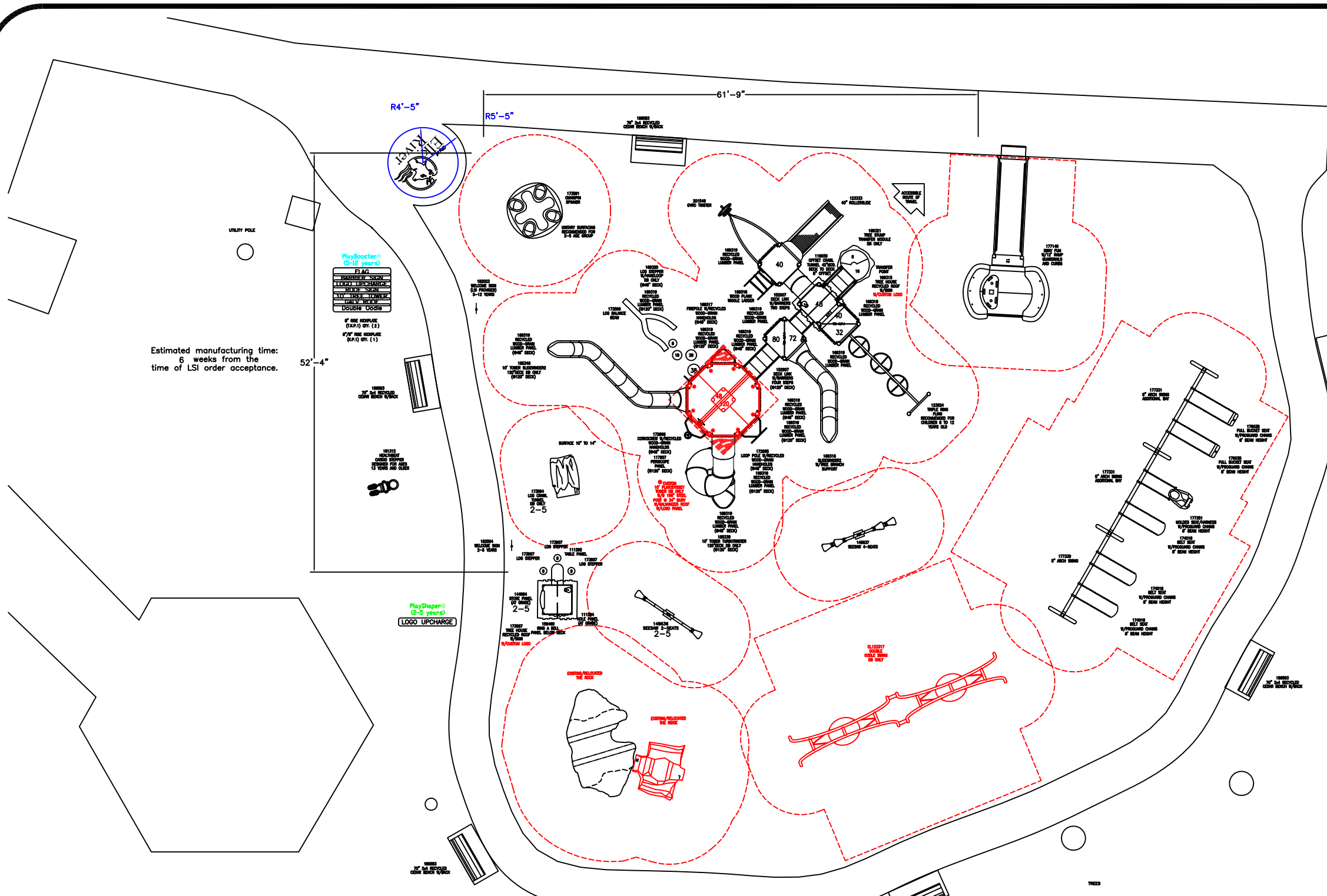

Estimated manufacturing time: 6 weeks from the time of LSI order acceptance.

PlayBooster® (5-12 years)

ITEM	QUANTITY	NOTES
11100	1	11100
11101	1	11101
11102	1	11102
11103	1	11103
11104	1	11104
11105	1	11105
11106	1	11106
11107	1	11107
11108	1	11108
11109	1	11109
11110	1	11110
11111	1	11111
11112	1	11112
11113	1	11113
11114	1	11114
11115	1	11115
11116	1	11116
11117	1	11117
11118	1	11118
11119	1	11119
11120	1	11120
11121	1	11121
11122	1	11122
11123	1	11123
11124	1	11124
11125	1	11125
11126	1	11126
11127	1	11127
11128	1	11128
11129	1	11129
11130	1	11130
11131	1	11131
11132	1	11132
11133	1	11133
11134	1	11134
11135	1	11135
11136	1	11136
11137	1	11137
11138	1	11138
11139	1	11139
11140	1	11140
11141	1	11141
11142	1	11142
11143	1	11143
11144	1	11144
11145	1	11145
11146	1	11146
11147	1	11147
11148	1	11148
11149	1	11149
11150	1	11150
11151	1	11151
11152	1	11152
11153	1	11153
11154	1	11154
11155	1	11155
11156	1	11156
11157	1	11157
11158	1	11158
11159	1	11159
11160	1	11160
11161	1	11161
11162	1	11162
11163	1	11163
11164	1	11164
11165	1	11165
11166	1	11166
11167	1	11167
11168	1	11168
11169	1	11169
11170	1	11170
11171	1	11171
11172	1	11172
11173	1	11173
11174	1	11174
11175	1	11175
11176	1	11176
11177	1	11177
11178	1	11178
11179	1	11179
11180	1	11180
11181	1	11181
11182	1	11182
11183	1	11183
11184	1	11184
11185	1	11185
11186	1	11186
11187	1	11187
11188	1	11188
11189	1	11189
11190	1	11190
11191	1	11191
11192	1	11192
11193	1	11193
11194	1	11194
11195	1	11195
11196	1	11196
11197	1	11197
11198	1	11198
11199	1	11199
11200	1	11200

PlayBooster® (2-5 years)
LOGO UPCHARGE

2-5 THE MAXIMUM FALL HEIGHT OF THIS STRUCTURE IS 37"

TOTAL ELEVATED PLAY COMPONENTS	0	REQUIRED	0
TOTAL ELEVATED COMPONENTS ACCESSIBLE BY RAMP	0	REQUIRED	0
TOTAL ELEVATED COMPONENTS ACCESSIBLE BY TRANSFER	0	REQUIRED	0
TOTAL ACCESSIBLE GROUND LEVEL COMPONENTS SHOWN	6	REQUIRED	0
TOTAL DIFFERENT TYPES OF GROUND LEVEL COMPONENTS	6	REQUIRED	6

5-12 THE MAXIMUM FALL HEIGHT OF THIS STRUCTURE IS 120"

TOTAL ELEVATED PLAY COMPONENTS	13	REQUIRED	0
TOTAL ELEVATED COMPONENTS ACCESSIBLE BY RAMP	0	REQUIRED	0
TOTAL ELEVATED COMPONENTS ACCESSIBLE BY TRANSFER	8	REQUIRED	7
TOTAL ACCESSIBLE GROUND LEVEL COMPONENTS SHOWN	15	REQUIRED	4
TOTAL DIFFERENT TYPES OF GROUND LEVEL COMPONENTS	8	REQUIRED	8

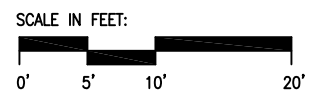

Orono Park
Elk River, MN

SYSTEM TYPE:
PlayBooster
DRAWING #:
62230-1-5

